

# PhotoFold™

## 5" Photoetch Bending Tool

PFT-5  
Rev. 1



### INTRODUCTION

Thank you for purchasing ParaGrafix's PhotoFold photoetch bending tool. Unlike traditional "clamp-and-blade" bending tools, PhotoFold mimics the action of a machine shop's sheet metal bending brake. This provides for a more natural bending action, while helping to ensure that parts fold only where desired.

You may also be interested in viewing our video instructions for this product at <http://www.paragrafix.biz/video-instructions-1.asp>. Here you will see how to assemble PhotoFold and also see the tool in action. (Note that although the instructions show the Rev.0 version of PhotoFold, they are still applicable.)

### Assembly

**IMPORTANT NOTE:** Stainless steel is very strong ... but it is also brittle. Do not try to unfold/refold any of the pieces as they will likely break off.

PhotoFold consists of three parts: the bed (A), bending leaf (B), and the upper leaf or die (C).

#### 1) Remove the parts from the main fret.

Although we usually suggest using a #14 Xacto blade and glass cutting board, in this case the stainless steel is too tough, so you should use dedicated photoetch scissors (such as those available from Xuron).

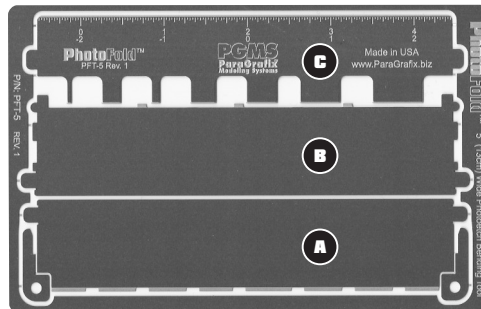

#### 2) Lay the hinge pins of the bending leaf into the holes of the hinge barrels.

Make sure that you place the folding leaf text side down so that the "teeth" at the joint between the two pieces line up. You may need to bend the leaf slightly so that its teeth slide under the bed.

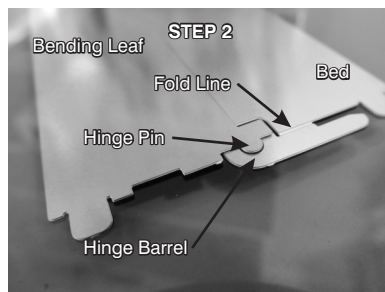

#### 3) Rotate the hinge barrels.

Make sure the barrels are at right angles to the bed, trapping the hinge pins of the bending leaf.

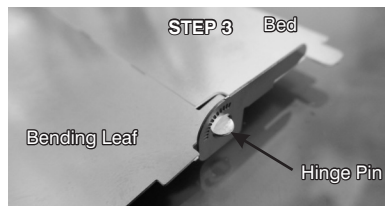

# PhotoFold™

## 5" Photoetch Bending Tool

PFT-5  
Rev. 1



### INTRODUCTION

Thank you for purchasing ParaGrafix's PhotoFold photoetch bending tool. Unlike traditional "clamp-and-blade" bending tools, PhotoFold mimics the action of a machine shop's sheet metal bending brake. This provides for a more natural bending action, while helping to ensure that parts fold only where desired.

You may also be interested in viewing our video instructions for this product at <http://www.paragrafix.biz/video-instructions-1.asp>. Here you will see how to assemble PhotoFold and also see the tool in action. (Note that although the instructions show the Rev.0 version of PhotoFold, they are still applicable.)

### Assembly

**IMPORTANT NOTE:** Stainless steel is very strong ... but it is also brittle. Do not try to unfold/refold any of the pieces as they will likely break off.

PhotoFold consists of three parts: the bed (A), bending leaf (B), and the upper leaf or die (C).

#### 1) Remove the parts from the main fret.

Although we usually suggest using a #14 Xacto blade and glass cutting board, in this case the stainless steel is too tough, so you should use dedicated photoetch scissors (such as those available from Xuron).

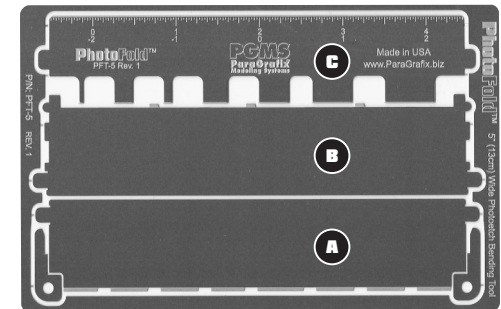

#### 2) Lay the hinge pins of the bending leaf into the holes of the hinge barrels.

Make sure that you place the folding leaf text side down so that the "teeth" at the joint between the two pieces line up. You may need to bend the leaf slightly so that its teeth slide under the bed.

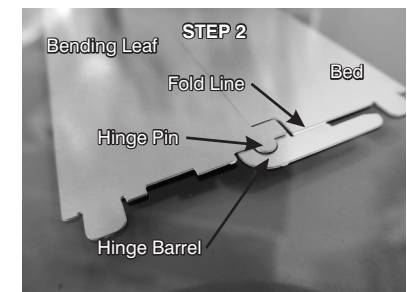

#### 3) Rotate the hinge barrels.

Make sure the barrels are at right angles to the bed, trapping the hinge pins of the bending leaf.

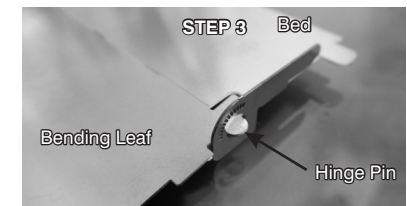

**4) Fold down the four legs (two on the bed and two on the bending leaf).**

This provides a stable working surface while you are using PhotoFold.

**5) Fold the "catches" on the die**

The catches stabilize the die when mounting it on the folding leaf side, and slip outside the bed when mounting from that side.

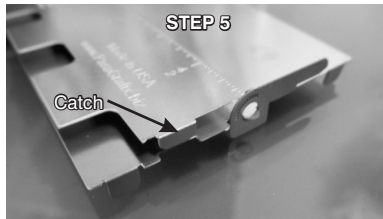
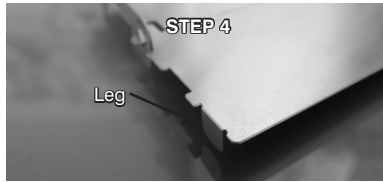

**4) Fold down the four legs (two on the bed and two on the bending leaf).**

This provides a stable working surface while you are using PhotoFold.

**5) Fold the "catches" on the die**

The catches stabilize the die when mounting it on the folding leaf side, and slip outside the bed when mounting from that side.

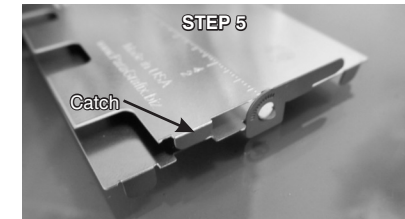
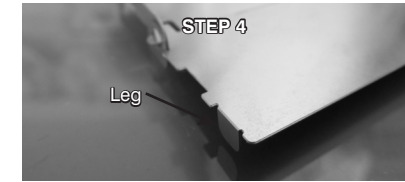

**Using PhotoFold - the Basics**

These instructions just provide the basics of using PhotoFold. For more information on folding photoetch, please see our videos located at: <http://www.paragrafix.biz/video-instructions-1.asp>. These videos show more on using photoetch in general as well as PhotoFold specifically.

**A) Place the etch piece to be folded PhotoFold.**

The fold line should be facing up, with one edge aligned with the intersection of the bed and bending leaf, with the fold line extending over the folding leaf.

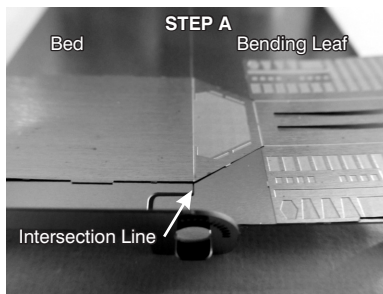

**B) Slide the die entirely into the slots on the bed, or drop it over the notches on the folding leaf.**

You may have to reposition the part to be bent. Although finger pressure will usually hold the die in place, you can also clamp it with a binder clip (AKA banker's clip or foldover clip).

**TIP:** You can reverse steps A and B if you find it easier to slide the etch part under the die.

**C) Fold PhotoFold to form the piece.**

Keep firm pressure on both the bed/die and the bending leaf for best results.

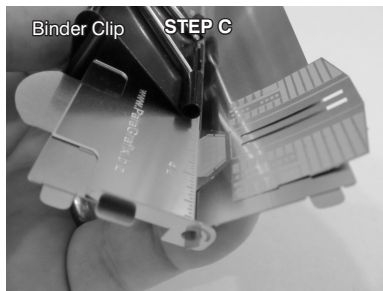

**Using PhotoFold - the Basics**

These instructions just provide the basics of using PhotoFold. For more information on folding photoetch, please see our videos located at: <http://www.paragrafix.biz/video-instructions-1.asp>. These videos show more on using photoetch in general as well as PhotoFold specifically.

**A) Place the etch piece to be folded PhotoFold.**

The fold line should be facing up, with one edge aligned with the intersection of the bed and bending leaf, with the fold line extending over the folding leaf.

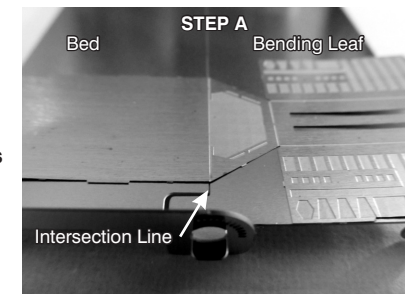

**B) Slide the die entirely into the slots on the bed, or drop it over the notches on the folding leaf.**

You may have to reposition the part to be bent. Although finger pressure will usually hold the die in place, you can also clamp it with a binder clip (AKA banker's clip or foldover clip).

**TIP:** You can reverse steps A and B if you find it easier to slide the etch part under the die.

**C) Fold PhotoFold to form the piece.**

Keep firm pressure on both the bed/die and the bending leaf for best results.

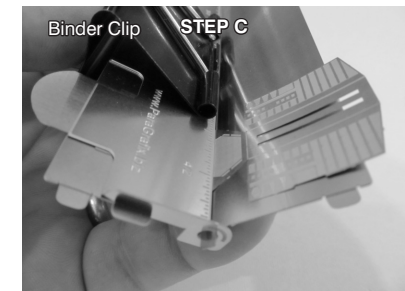

**PhotoFold™**

148 Rocklawn Ave.  
Attleboro MA 02703 USA  
+1 508-431-9800  
www.ParaGrafix.biz

Copyright © 2012 Paul H. Bodensiek. All rights reserved.  
ParaGrafix™, PGMS™, and PhotoFold™ are TM Paul H. Bodensiek.



**PhotoFold™**

148 Rocklawn Ave.  
Attleboro MA 02703 USA  
+1 508-431-9800  
www.ParaGrafix.biz

Copyright © 2012 Paul H. Bodensiek. All rights reserved.  
ParaGrafix™, PGMS™, and PhotoFold™ are TM Paul H. Bodensiek.