

# MOON SUIT

## Photoetch Set

**PARA  
GRAFIX™**  
PGX251

ParaGrafix states that our use of the trademarked terms listed below in our product descriptions constitutes fair use and nominative use and is in no way to offer confusion that ParaGrafix and any of the following noted trademark holders are related companies, nor do we state that we are endorsed by these trademark holders. We are an AFTERMARKET company acting in GOOD FAITH in providing high quality products to loyal customers who have already purchased products related to these trademarks. ParaGrafix is actually providing these trademark holders a venue of free advertising and indirectly provide these trademark holders with more sales leads. Monarch® is a registered trademark of Monarch Model Company, Inc. All rights reserved.

### INTRODUCTION

Thank you for purchasing ParaGrafix's photoetch set for Monarch's Moon Suit kit. Since the suit never saw active space duty, this set is intended to add more realism for a "real" space suit rather than as exact duplications of any actual details. We hope you enjoy it!

### Materials

In addition to the photoetch, you will also need scissors or a knife\* to remove individual pieces from the main fret, a file to remove material left from cutting, and super glue (aka CA or cyanoacrylate). Additionally, to fold some pieces, you will need a pair of razor blades\*\* or a specialty tool such as PhotoFold from ParaGrafix.

\* We prefer Xuron's Professional Photoetch Scissors (#9180ET) or a #17 Xacto chisel blade.

\*\* Extreme care must be taken when using razor blades. Risk of serious injury.

### Raised Detail

Where applicable, these instructions note an area where the raised kit detail must be removed. The symbol at left will show you where this needs to happen. This may be done in whatever way you are most comfortable: sanding, filing, chiseling. Note that in most cases the surface does not need to be perfectly smooth as the photoetched part will replace the "lost" kit detail.

### Lighting Options

Unless otherwise noted, you can prep areas for lighting by removing plastic from areas where there are through holes in the photoetch. You can then backlight the photoetch. For best results, we suggest using Micro Kristal Klear from Microscale Industries ([www.microscale.com](http://www.microscale.com)) to fill the through holes. MKK can be tinted for different colored lights.

### Installation Parts Order

The installation steps are not in any particular order. You can complete them as you see fit to complement your kit construction order.

### Key

Kit part (plastic): **n/a**

Photoetched part: **1**

Backlight Film: **A**

### Stantions

**TIP:** File down the kit stantions to fit flush with the grooves to support the outside ribs (7).

Attach the inner (8) and outside (7) ribs at each of the 3 locations as shown.



### Helmet "Ceiling"

**NOTE:** Etch piece 2 is intended to cover the roughly molded, as well as provide space for hiding any wiring used for lighting the upper beacon. Install all lighting before attaching this piece.

Mount etch piece 2 to the helmet top lid as shown. Note the small notch that aligns with the tab on the kit part.

If lighting, you can route wiring through any of the 3 holes along the edge of the etch piece, covering unused holes with etch part 5.

If not lighting, use etch part 5 to cover up the holes in the etch piece.

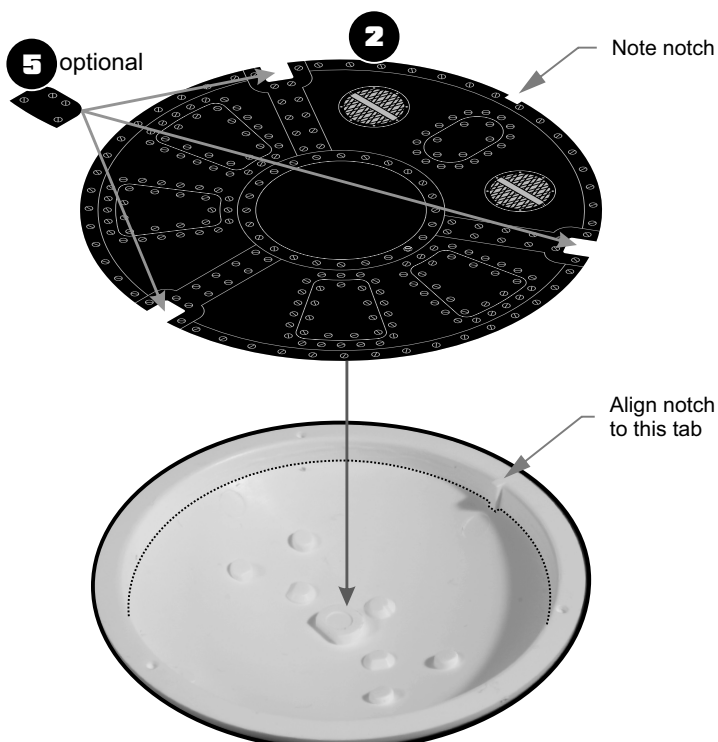

## Control Panel

Remove the raised detail from the surface of the kit's control panel.

**NOTE:** If you will be lighting your Moon Suit, also remove the material from this area. You will also want to use some sheet plastic to box in this control panel to avoid light leaks. Replace with photoetch part 4 and backlight film A. (3 copies of A are included.)

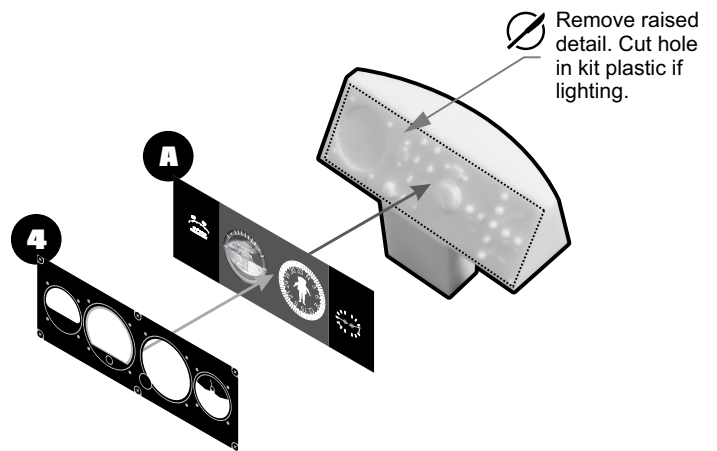

## Vent Grills

Glue the two etch grills (etch parts 1 and 3) in place as shown.

**NOTE:** If desired, etch grill 1 can be added before the vent housing is attached to the kit.

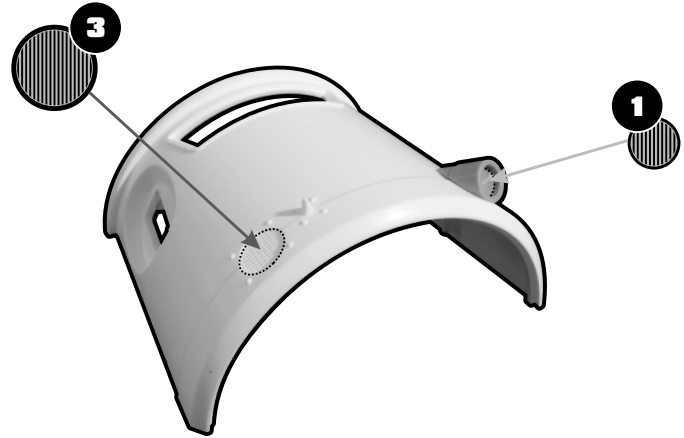

## Window Frames

### Remove Molded in Bolts

Remove the raised bolts from the window frames in the front torso and bottom pan. Leave the window frames themselves in place.

### Add "Glass"

Mount the glass into the torso and pan per the kit instructions.

### Mount Window Frames

**TIP:** Although they are very flexible, you might consider annealing etch parts 9 and 10. This will allow them to more easily take on the shape of the torso without springing back in the future.

**NOTE:** The round window on the pan is not actually circular. Rotate parts 6 until they line up properly before gluing in place.

**NOTE:** Etch part 12 is made to fit around the leg mounts in the pan. A second part 11 is included for use if you modify the leg area inside the kit.

Attach the window frames as shown.

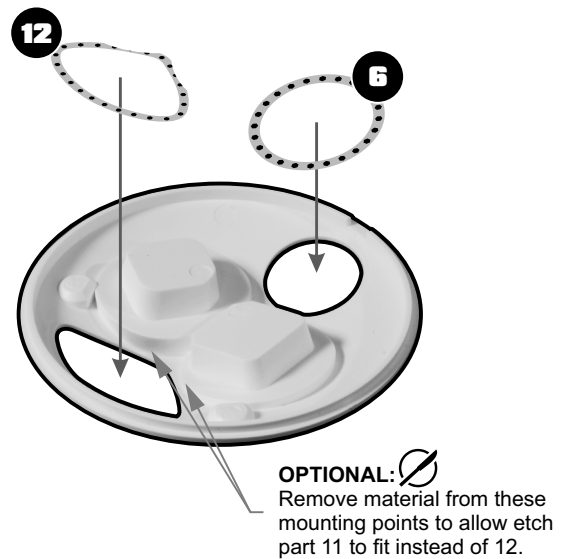
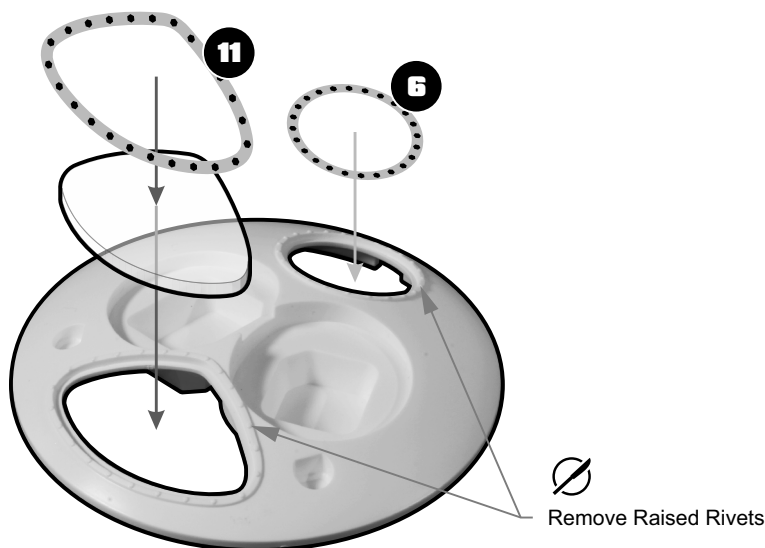
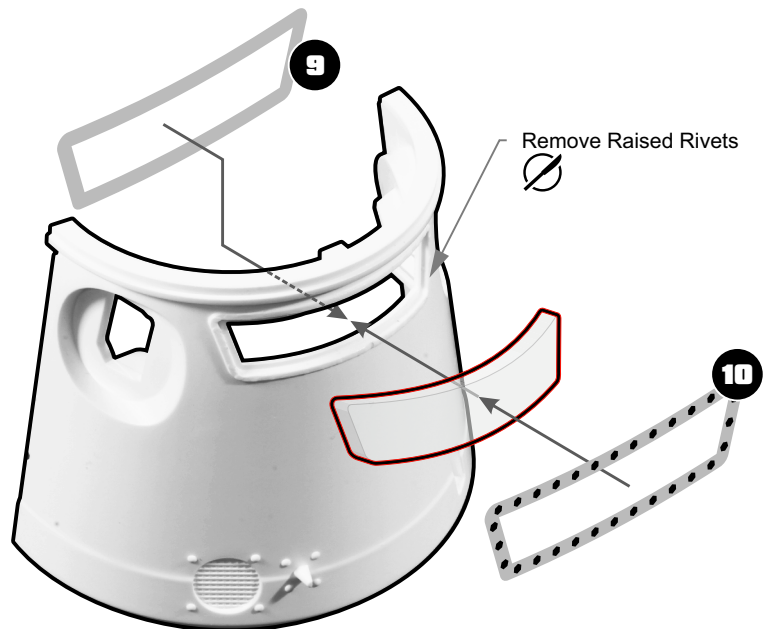

Attleboro MA 02703 USA  
+1 508-431-9800  
www.ParaGrafix.biz